

HOFGAS[®] - IFL4c

Flare for operation under irregular conditions in keeping with gas-emission regulations

Standard flare for sewage- or biogas plants. Efficient and logical solution with systems operating under irregular conditions.

The **HOFGASⁱ - IFL4c** flare come to be used when express limits relating to gas emissions must be observed. Because of no visible flame, erection of the flare is most advantageous even near residential areas.

Automatic combustion control with changing pressure- or flow ratios. The plant is simple to operate, tune in, and starts reliably. The flare comes with the latest safety technology.

Is highly adaptable to irregular operating conditions.



HOFGAS[®]-IFL4c 1500

- ✓ Ideal for irregular operating conditions
- ✓ Automatic combustion control
- ✓ Emission levels are kept within current regulations (TA-Luft, EA Standards, etc.)
- ✓ Concealed flame
- ✓ Combustion temperature > 900°C
- ✓ Residence time ≥ 0.3s
- ✓ High standards of safety

General specifications

Gas flow rate	60 - 4'000 Nm ³ /h
Burner capacity up to	32'000 kW
Methane concentration	60 - 75 vol. %
Combustion temperature	> 900 °C
Residence time	> 0.3 s
Initial gas pressure	25 - 150 mbar
Expected sound pressure level at full load (at 15m distance and 2m height)	< 69 dB(A)

Safety features

- Flame arrester
- Slam shut valve
- Burner control unit with UV detection
- Monitoring of temperature in combustion chamber

Site preparation

- Preparation of location (fence, access road etc.)
- Foundation
- Pre-dewatering
- Electricity supply
- Pipeline connection

Options

- Frost protection
- Low noise combustion

More options are available on request

HOFGAS[®] - IFL4c

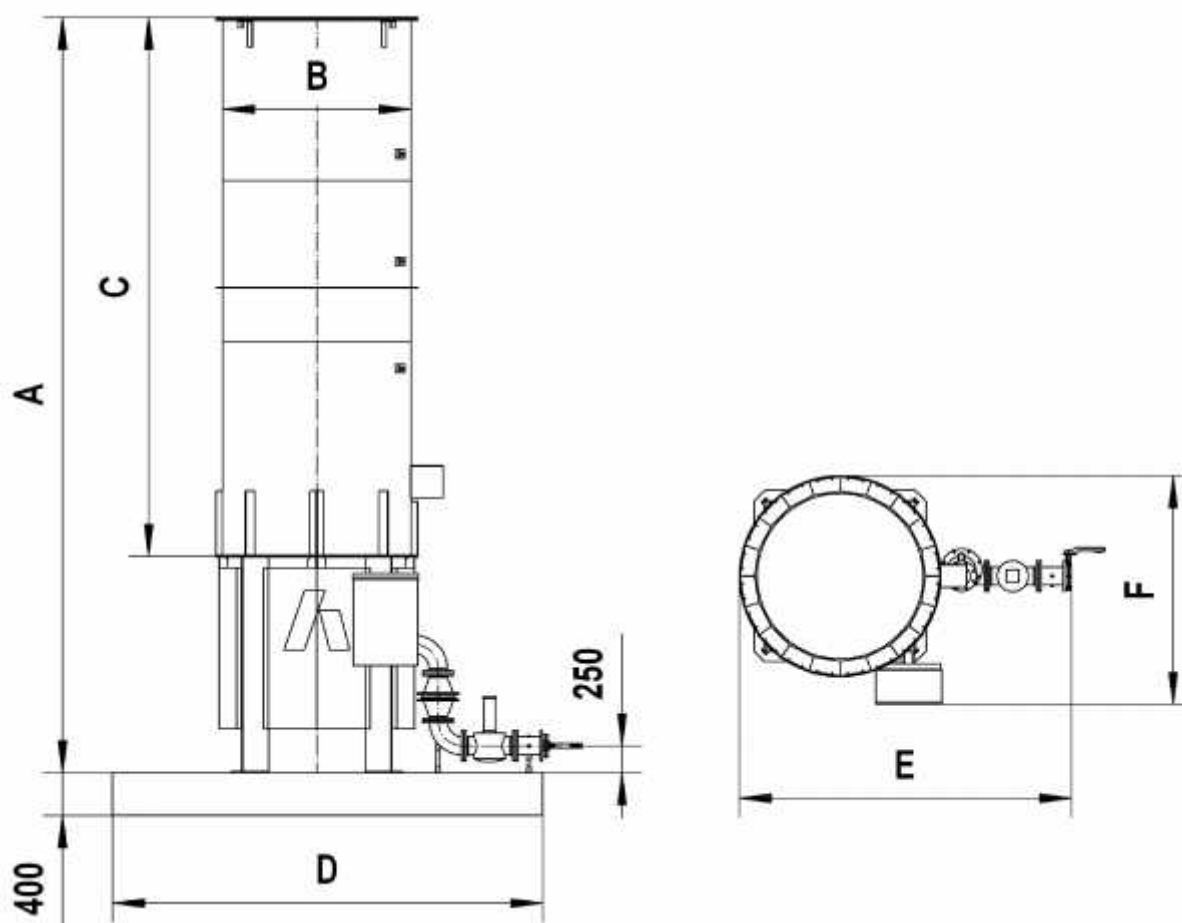

Specification for standard installations

HOFGAS ⁱ -	Gas flow rate (max.) Nm ³ /h	Burner capacity (max.) kW	Flange connection DN/PN	Initial gas pressure at full load (min.) mbar	Dimension A mm	Dimension B mm	Dimension C mm	Dimension D mm	Dimension E mm	Dimension F mm	Weight (approx.) kg
<i>IFL4c 60</i>	60	450	50/16	25	5'300	Ø 720	3'500	2'500	1'120	1'140	700
<i>IFL4c 90</i>	90	675	50/16	25	5'800	Ø 800	4'000	2'500	1'200	1'220	900
<i>IFL4c 180</i>	180	1'350	80/16	25	6'500	Ø 960	4'500	3'000	1'350	1'420	1'200
<i>IFL4c 360</i>	360	2'700	100/16	25	6'500	Ø 1'280	4'500	3'000	1'690	1'700	1'400
<i>IFL4c 500</i>	500	3'750	125/16	25	6'500	Ø 1'440	4'500	4'000	1'900	1'810	1'800
<i>IFL4c 650</i>	650	4'875	150/16	25	7'000	Ø 1'590	5'000	4'000	2'170	2'130	2'200
<i>IFL4c 1000</i>	1'000	7'500	200/16	25	7'000	Ø 1'760	5'000	4'000	2'290	2'300	2'600
<i>IFL4c 1250</i>	1'250	9'375	200/16	25	7'700	Ø 1'920	5'500	4'000	3'210	2'440	3'000
<i>IFL4c 1500</i>	1'500	11'250	250/16	25	8'200	Ø 2'070	6'000	4'000	3'330	2'600	3'600
<i>IFL4c 2000</i>	2'000	15'000	250/16	30	8'200	Ø 2'240	6'000	4'000	3'470	2'770	3'900
<i>IFL4c 2500.. 4000 on request</i>											